

A PROJECT BY



CORPORATE OFFICE

A/604, TIRUPATI PLAZA,  
ATHWAGATE, NANPURA,  
SURAT.

PH.NO.- 0261 2461771

website : [www.bardoliagroup.com](http://www.bardoliagroup.com)

e-mail : [bardoliagroup@gmail.com](mailto:bardoliagroup@gmail.com)



**Sai**  
**Aashish Paradise**  
3 BHK Premium Apartments



S.R. DESIGNS - 98253 46393



Welcome to Sai Aashish Paradise.

Something very sleek and sophisticated for class apart space is peeping up in your lives for becoming you eternal part as your private space. Yes, it's here in your city where you would really want to have your own settings to live your life. It's yet another latest venture of high-end residential space by none other than renowned Sai Aashish Paradise.

3 BHK PREMIUM APARTMENTS

A UNIQUE  
LIFESTYLE  
OF YOUR  
OWN



# EMBRACE THE MODERN ARCHITECTURE

Derive four lives with newer level of aptness within the  
airs of impeccably designed structures in a widespread  
portion of land. These will be the homes that you will  
cherish-in for their eye-grabbing formation right from  
the classic exteriors itself.



## EMBRACE THE ROYAL WELCOME

The glorious and grand entrance welcomes you to the world of elite living. These beautifully designed residences with its coveted location, stunning design and thoughtful amenities surpass every definition of luxury and reflect the beauty of high-life.





## EMBRACE THE WONDERFUL LIFE

A magnificent world called Sai Aashish Paradise that is effortlessly Luxurious, quietly elegant and exclusively yours. It is a reflection of your dreams, desires, aspirations and choices. A true reflection of who you are. Live here and move closer to happiness.

CHILDREN PLAY AREA | GAME ZONE | LANDSCAPE GARDEN



## EMBRACE THE JOYFUL AMENITIES

You hear a lot about green. Combining results today with strategy tomorrow. Keep clean and make a global footprint. Your residence has to support that. This is where Sai Aashish Paradise stand by you. Fully ventilated, nicely architecture apartments satisfy elevated life style. They are adjoined with decent and green build up. Butterfly lawn, Sitting area, Children play area. Experience a pleasant surprise!





**Sai**  
**Aashish Paradise**  
3 BHK Premium Apartments

**Ground Floor**  
Layout Plan

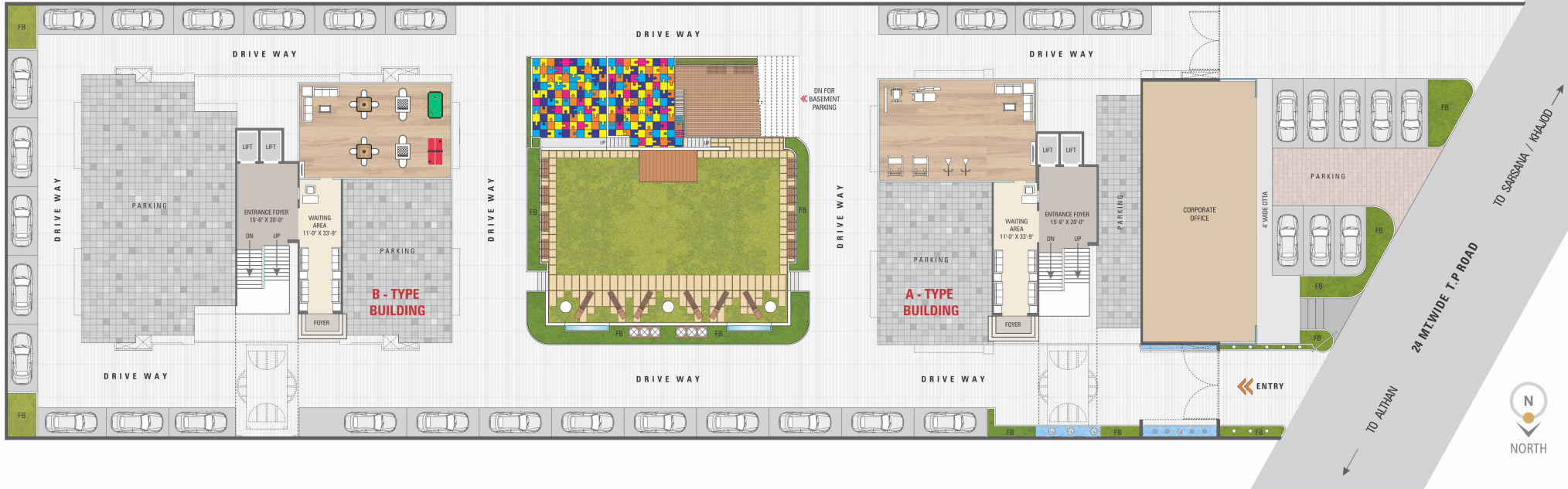

**Typical Floor**  
Layout Plan

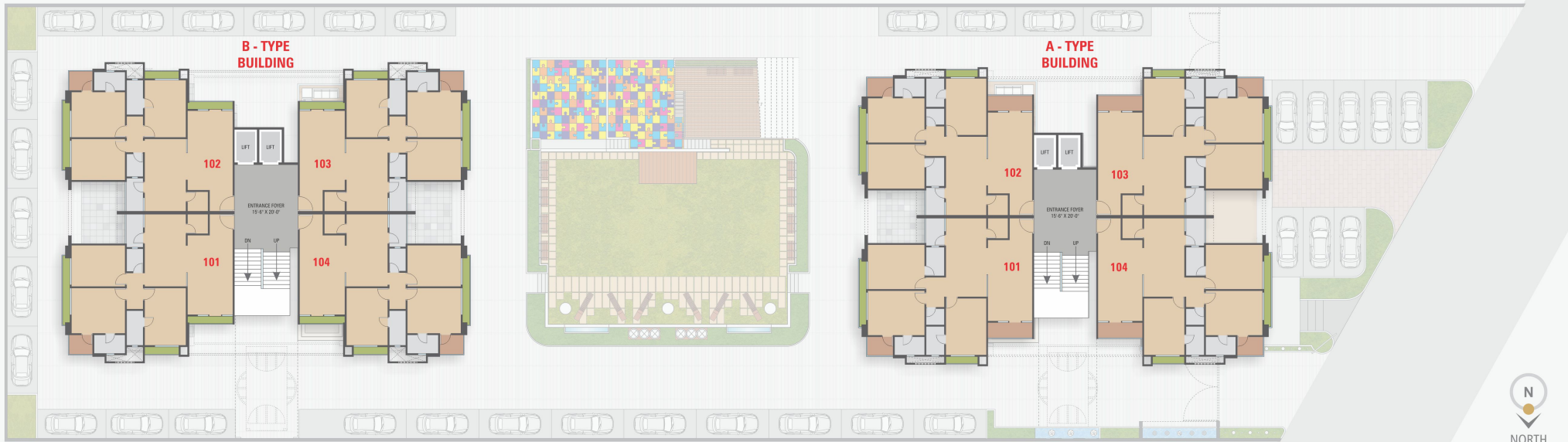





### 3 BHK TYPICAL FLOOR PLAN

**A - BUILDING**  
1<sup>ST</sup> TO 14<sup>TH</sup> FLOOR



### A - BUILDING UNIT PLAN

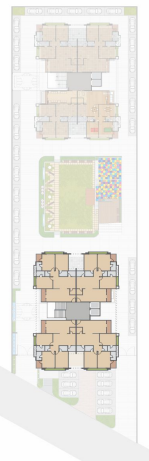



# 3 BHK TYPICAL FLOOR PLAN

 **B - BUILDING**  
1<sup>ST</sup> TO 14<sup>TH</sup> FLOOR



# B - BUILDING UNIT PLAN





**Sai**  
**Aashish Paradise**  
3 BHK Premium Apartments

A much more than a home, it's a heavenly sight...  
Taking your happiness to The new heights!



# APARTMENT AMENITIES

- 32"X32" Granamite tiles in Living, Kitchen & Dining Area.
- Wooden tiles flooring in Master Bedroom.
- 24"X24" Granamite tiles in Bedroom.
- Granite with glazed tiles dedo in store.
- Gas Chimney and Water Filter provision in kitchen.
- Wooden frame with best quality water proof flush doors.
- Upvc windows.
- Internal wall with putty finish.
- 8 points power backup.
- 2 cars parking allotted.
- Standard company make C.P bathroom fittings.
- 10' floor height slab to slab.
- Automatic branded standard lifts.
- Granite Kitchen platform with S.S sink.
- Modular standard company switches and wiring.
- Branded company plumbing and drainage pipes.
- Designer tiles on floor and walls with standard sanitarities in Toilet.
- Designer S.S grills in windows for safety.
- Internet-Wifi enabled cables.
- Dish TV connection will be provided.
- Centralised Gas Geyser piping in all bathrooms.

# CAMPUS FEATURES

- Exclusively designed landscape with large open area.
- Basement Parking area.
- Senior Citizen siting area.
- CCTV coverage of entire common area.
- Intercom and High tech security system.
- Multipurpose Hall / Exercise and Aerobics Hall.
- Marvellous Entrance Gate with Security Cabin.
- Children Play Area.
- Game Zone.
- Sufficient power generator back-up for common area.
- Well designed compound walls with lights.
- Fire safety provisions.
- Structure design considering last Earth-Quake.
- 14-storey Apartments.
- Loanable clear title



### TERMS & CONDITION

- \* CONTINUOUS DEFAULT OF PAYMENT LEADS TO BE CANCELLATION.
- \* INTERNAL & EXTERNAL CHANGES ARE STRICTLY RESTRICTED DURING CONSTRUCTION AND AFTER COMPLETION OF PROJECT.

### LEGAL, SALE DEED AND EXTRA CHARGES:-

- Stamp duty, Registration fees, Advocate fees, Service tax & GST, Incremental contribution of SMC and other legal charges etc, all GEB exp. (quotation, contractor, internal cable, common accessories, transformers, other charges etc), If any changes in rules and regulation & by laws (during or after completion of construction work) of local and government authorities, implementation of RERA, it's should bound to all purchaser/members/allottee. • Full and final payment with legal & extra other charges is must be paid before sale deed registration & possession. • THIS BROCHURE IS ONLY FOR EASY UNDERSTANDING PURPOSE, it cannot make part of any legal agreement from developer. • Developer reserves the full rights to any change in plan and specifications as may be required. • Any additional taxes levied in future by the government shall be bound by all the purchaser.
- Society maintenance levied in advance it's shoul bound to all purchaser. • Subject to Surat jurisdiction.



LOCATION QR CODE

# LOCATION PLAN



### ARCHITECT



VASANT BARDOLIA  
DENISH BARDOLIA

**SHILP - MANDIR**

ARCHITECTURAL CONSULTANT

A/604, TIRUPATI PLAZA, ATHWAGATE, NANPURA,  
SURAT. PH.NO.-2461771, MOB.NO.-98250 52511  
e-mail : shilpmandir@gmail.com

### DEVELOPER



**VB Infrastructure**  
BARDOLIA GROUP

## BEST LOCATION BETTER CONNECTIVITY

Near By Petrol Pump	0.1 Km.	Diamond Bourse	1.0 Km.
Metro Station	0.2 Km.	Bhatar Char Rasta	2.0 Km.
Chamber of Commerce	0.3 Km.	City Light Junction	2.5 Km.
Khatu Shyam Temple	0.5 Km.	Domestic Airport	7.0 Km.
School & College	0.5 to 1.5 Km.	Railway Station	9.0 Km.

**CONTACT : +91 90990 27700**

**Site Address : Sai Aashish Paradise, Near Somiba Party Plot, Sarsana - Khajod Main Road, Bhimrad, Surat.**